

Party Assistant App

Welcome to the Party Assistant app guide!

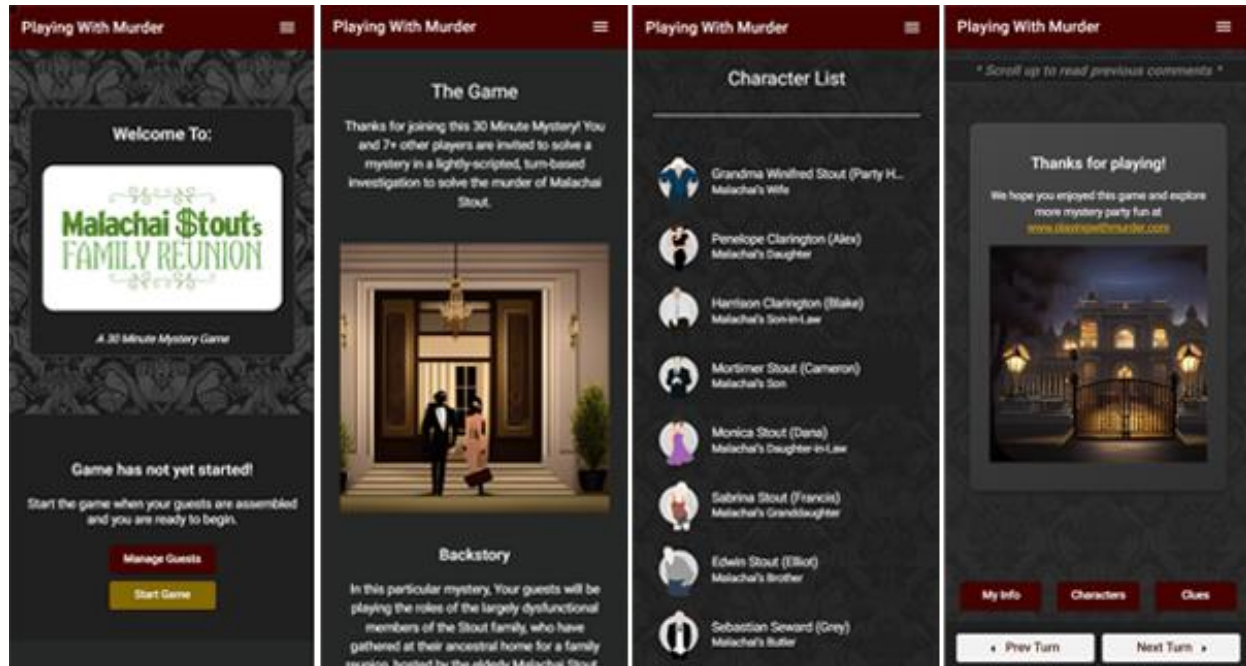

Screenshots from the Party Assistant app

The following pages will show you how to host your party with the app.

We recommend that you read the game guide (PDF) that came with your purchase before reading this app guide.

Getting Started

You can open the Party Assistant app by visiting <https://pwm30mm.web.app/> on any device (smartphone, tablet, laptop/desktop) with a browser (Chrome, Safari, Microsoft Edge, etc).

Tip: We recommend adding that link to your favorites/bookmarks/homescreen for easy access to the app.

For mobile users, here is how you can add the app to your homescreen.

On iOS

- 1) Open the app in Safari (using link above)
- 2) Select the share icon 
- 3) Scroll down the option list and select "Add to Home Screen"
- 4) Select "Add" (change the name first if you'd like; we recommend "PWM")

On Android

- 1) Open the app in Chrome (using link above)
- 2) Tap the three-dot menu (:) in the upper-right corner
- 3) Select "Add to Home screen"
- 4) Select "Add" (change the name first if you'd like; we recommend "PWM")
- 5) Choose where to place the shortcut (tap "Add to Home screen" or drag the icon where you want it).

The process may vary by device, but it will look something like this:

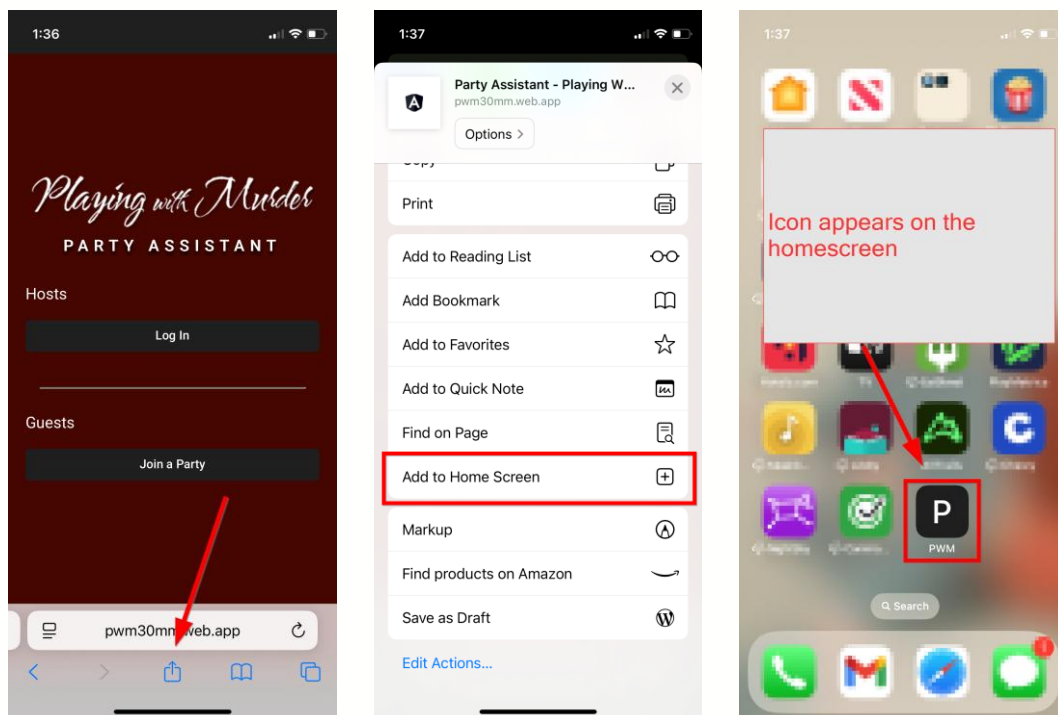

Creating Your Party

Begin by selecting “Log In” (first screenshot) and log in with the account you created on PlayingWithMurder.com.

Next, create your party by selecting the “Add New Party” button (second screenshot) and entering your party information (third screenshot).

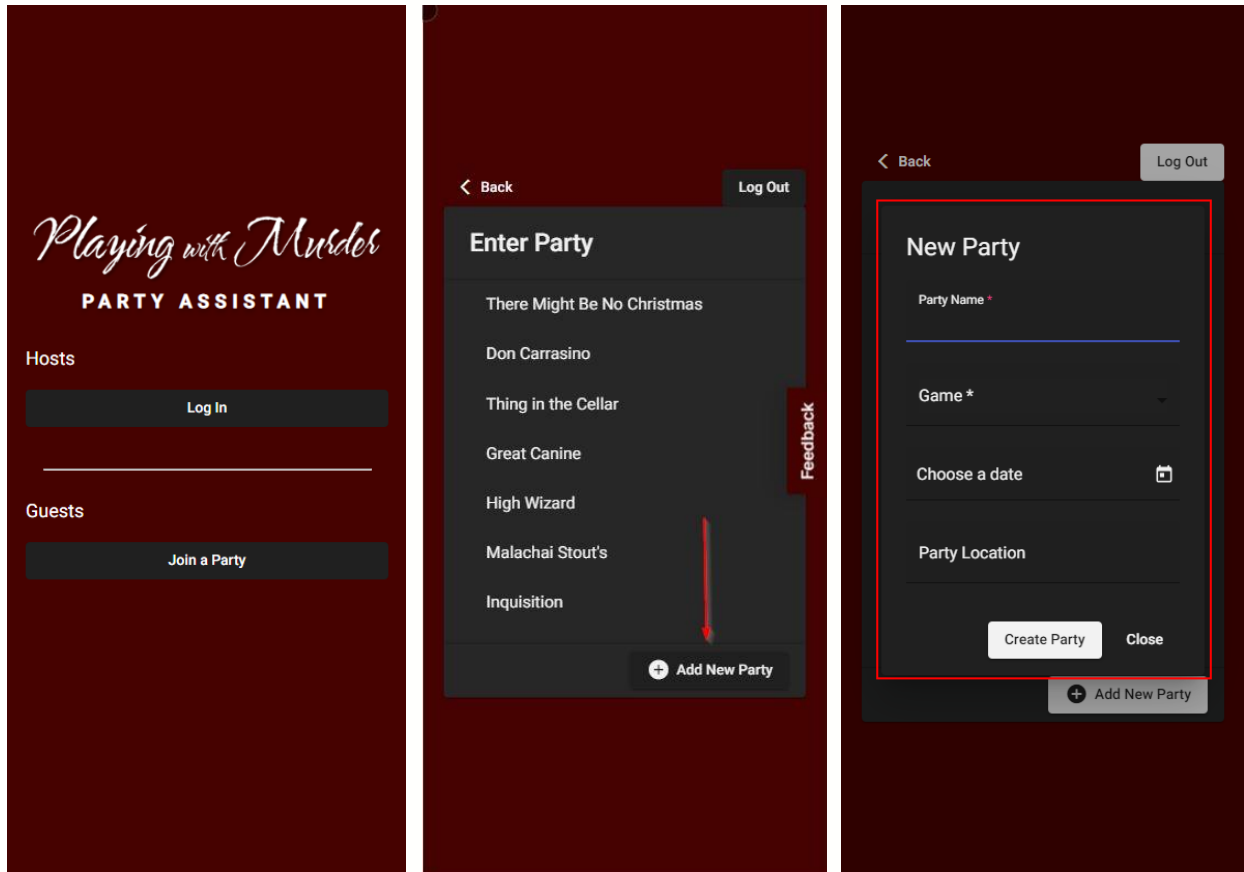

Managing Your Guests

Select the “Create or Edit Guest List” button (first screenshot) and then the “Add Guest” button (second screenshot) to add your first guest.

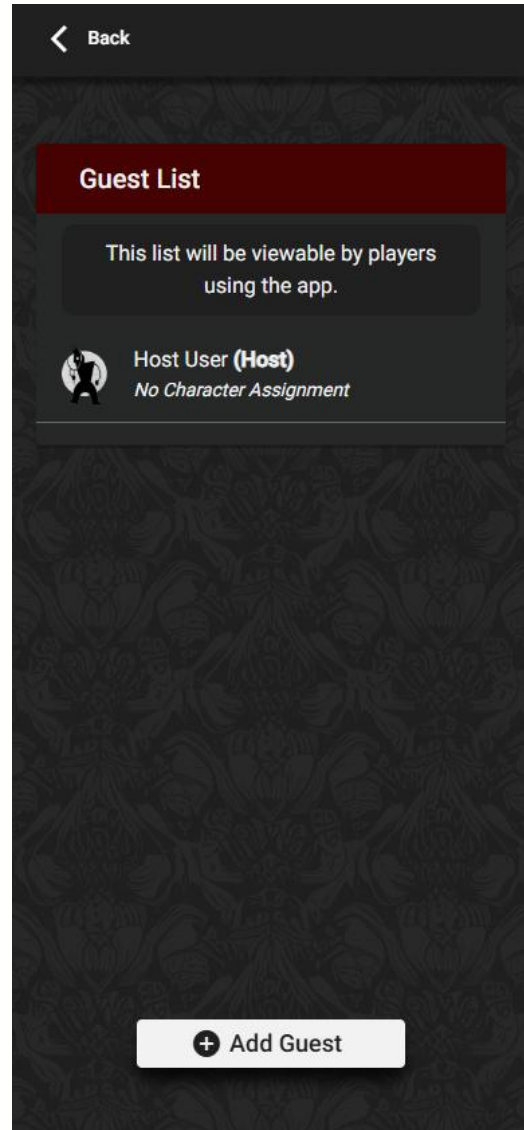

You will be prompted to select a character for the new guest. You may do this now or later, but all required characters will need to be assigned before the game can start. **Remember to assign yourself a character if you're playing along!**

Tip: You may find managing your guests using the app to be easier on a laptop/desktop computer, especially if you're running a large party with lots of guest entries and invitations. You can switch back-and-forth between different devices at any time as long as you're logged into the app using the same account on each device.

Inviting Your Guests

You will need to send each guest a **unique, personalized link** (generated by the app) for them to play the game as their assigned character when using the app.

Guest links can be found by selecting a guest (first screenshot) and copying from the Guest Link section (second screenshot).

The guest links are also included in a pre-made invitation that you can copy, edit and send to your guests (third screenshot), which is found on the same page.

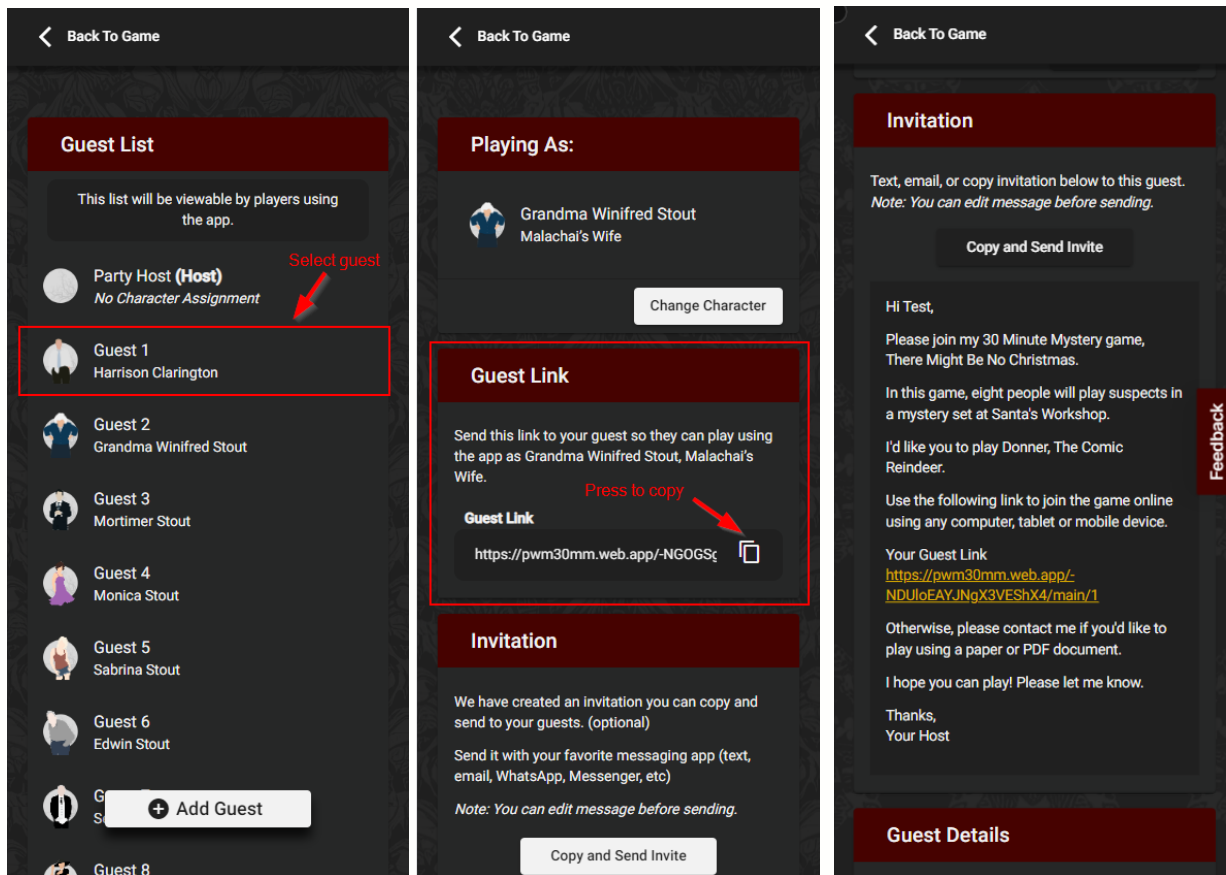

You can copy the entire pre-made invitation and send it using your preferred messaging app (text, email, Facebook Messenger, WhatsApp, etc) by selecting "Copy and Send Invite" button. Simply paste the invitation into the new, blank message and send to the appropriate guest.

Alternatively, you may copy the guest link by itself and add it to your own invitation.

Note: You will need to resend your guest's link if you change that guest's character assignment.

Preparing the Game

Once you have decided on a time, place, and guest list, the next step is sending out invitations and guest links and preparing optional game materials.

Sending Invitations & Guest Links

The earlier you send out the guest links, the more time your guests will have to get into character and prepare costumes (if you are using them). Alternatively, this game can be played casually at short notice with little preparation, so you can send out guest links shortly before the game in that case.

Generally, we recommend the following:

- Send out guest links **a minimum of 10 minutes before the game** so guests have enough time to learn about their character.
- Send out guest links **1-2 weeks before the game** if you'd like your guests to come in costume and/or have more time to immerse themselves into their character.

Backup Materials

We strongly recommend that you have at least one backup device ready in case a guest shows up with no device or has a technical issue with their device (battery dies, technical issues playing game, etc).

Alternatively, you can print out the paper versions of the character sheets as backups. This may be helpful if you are hosting an event where it is important that the game is played with minimal disruption (eg fundraiser, corporate event, large event, etc).

Optional Materials

Preparing Nametags

In-person games have the option of including printed nametags that are designed to fit into plastic ID badge holders that can be purchased at most hobby and craft stores. These nametags are found in the game guide (PDF) and should be handed out before the game, if you are using them.

Using Real Objects Instead of Paper Clues

The clues in this kit are printable pictures that you show to your guests during the game; however, some hosts take this a step further and replace these printed clues with real-life objects and scenes. For example, if the clue is a red pen, you can show an actual pen instead of the picture.

Running the Game

Once all your guests have been assigned characters and everyone is gathered for the game, you may select the “Begin Hosting” button (first screenshot) to open the step-by-step party guide.

The party guide will appear as a series of cards that contain instructions and task lists (second screenshot). Follow these instructions and complete the tasks to run the party.

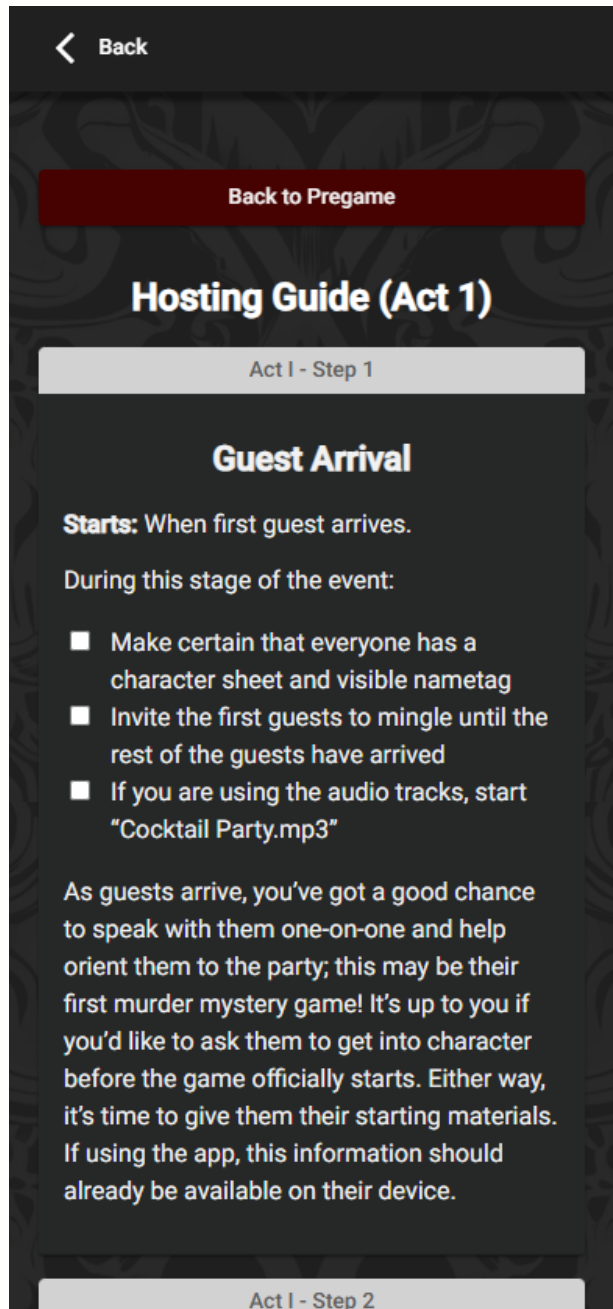
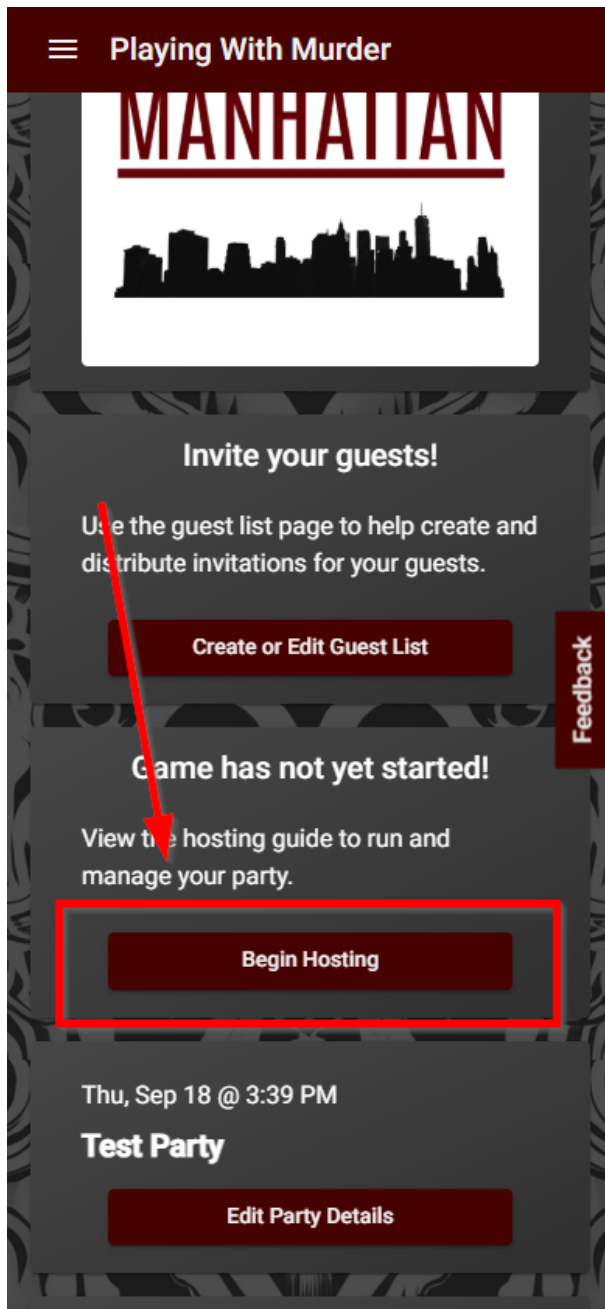

Running the Game (continued)

Instruct your guests to use the app by viewing their own character's information (first screenshot), as well as information about the other guests (second screenshot).

The app facilitates conversation among players by making details about other players easily accessible in both the "Guest List" and "Recently Viewed Characters" sections (see second screenshot).

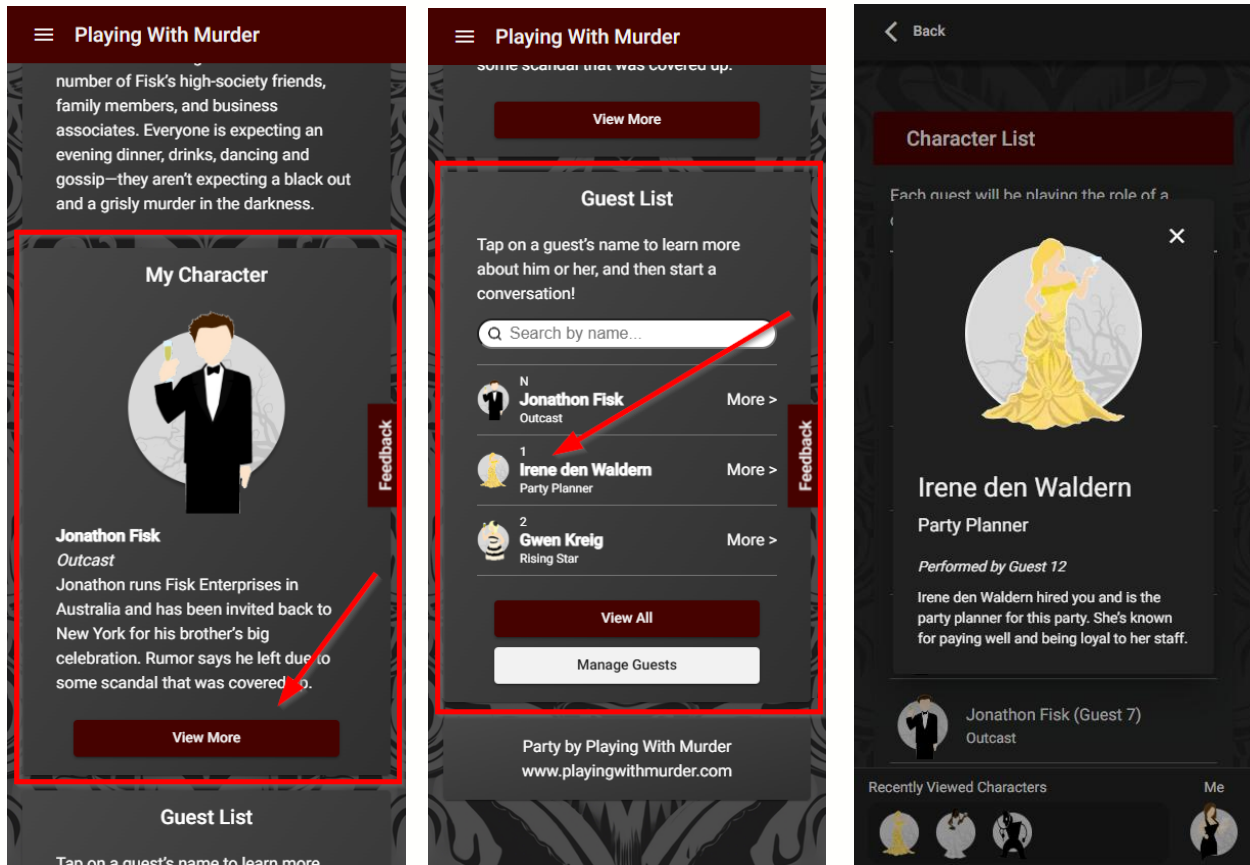

Your hosting guide will give you specific instructions about what your guests should do, but most of their use of the app will be to see background info about themselves and other players to give them ideas for things to discuss in their conversations with each other.

Running the Game (continued)

The Hosting Guide

As the host, you control the progress of the game from the hosting guide. Select “Begin Hosting” to enter the guide (see first screenshot).

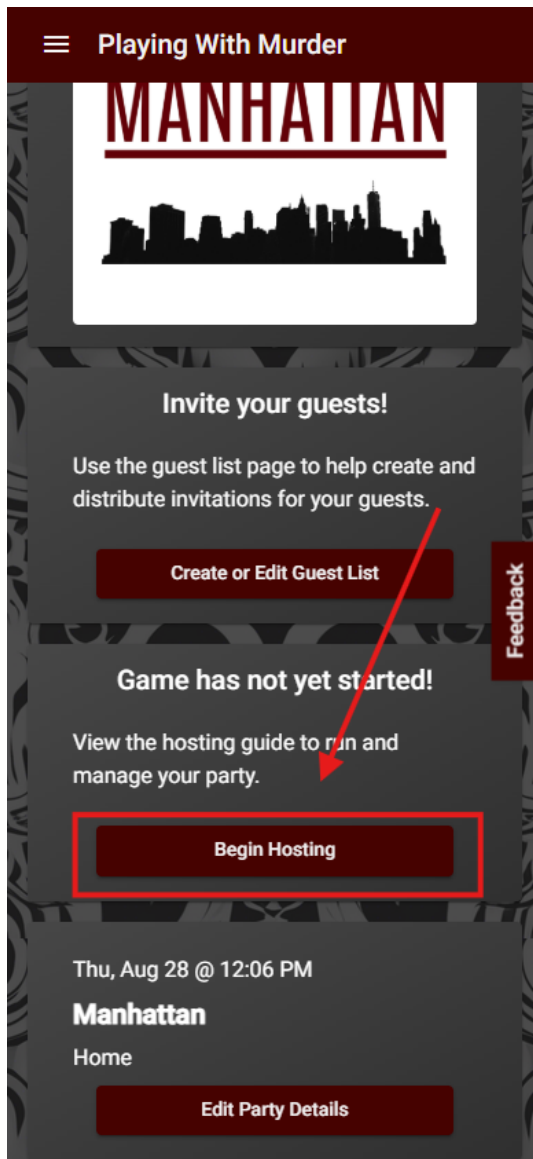

Navigating the Game's Stages

You'll start in the "Pregame" stage of the hosting guide. Once you've completed the pregame tasks, you'll select the "Start Act 1" button (see first screenshot), which will move the game forward to Act 1 and update what is shown in your guests' apps to Act 1 material.

You'll follow the same process to move the game to Act 2 and then to the game's conclusion.

You can always move backward to a previous act if needed with the "Back to..." buttons at the top and bottom of each screen. (see second screenshot)

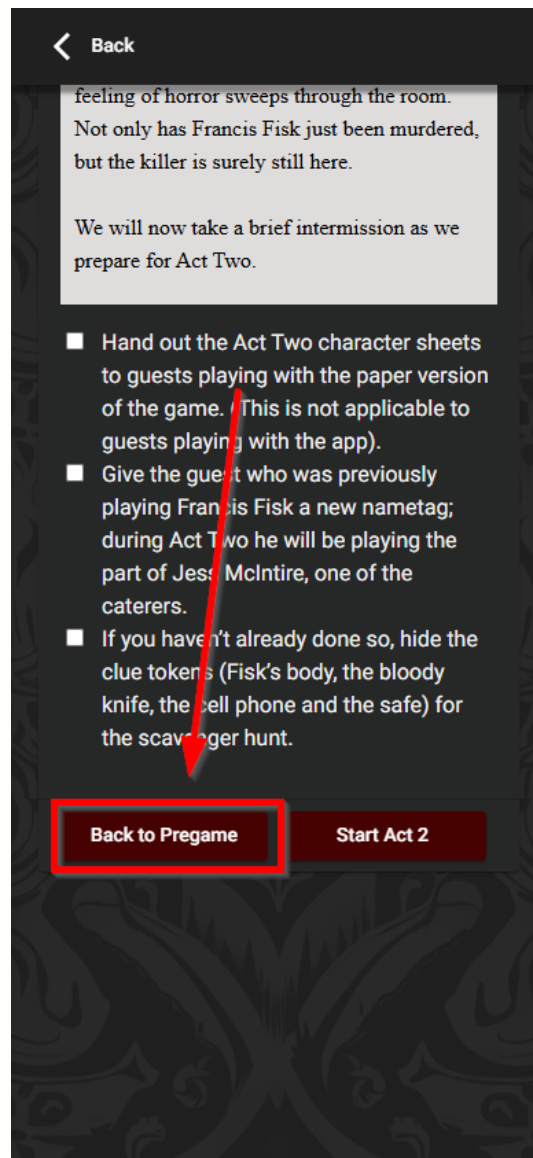
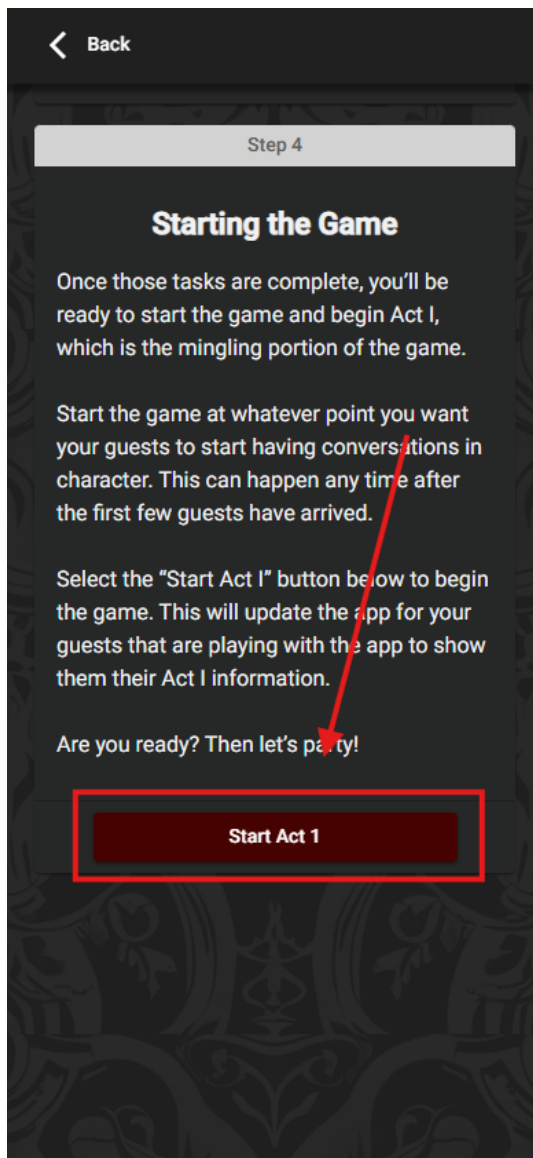

Running the Game (continued)

Clues & Scavenger Hunt

For most games, Act 2 contains a scavenger hunt portion where your guests seek out physical clue tokens that you've hidden in the playing area.

You can show the guests details about the clues as they're found by selecting "Unlock Clues" (first screenshot) and then selecting the word "Unlock" (second screenshot) next to the clue that was just found.

Once unlocked, your guests will be able to view the picture and description of the clue in their own app. An example of what they'll see is shown in the picture card below (second screenshot).

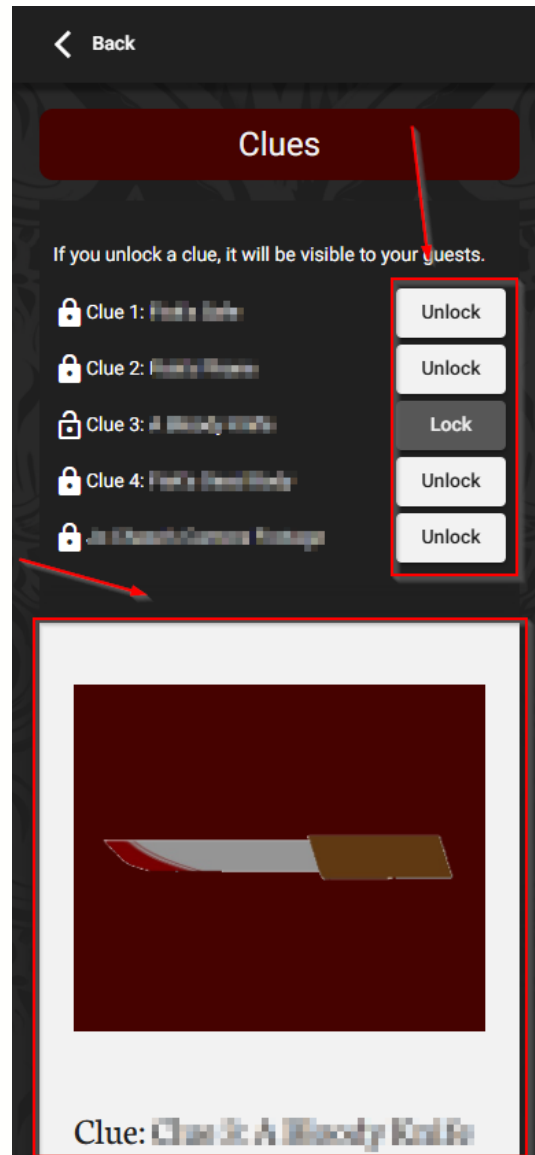
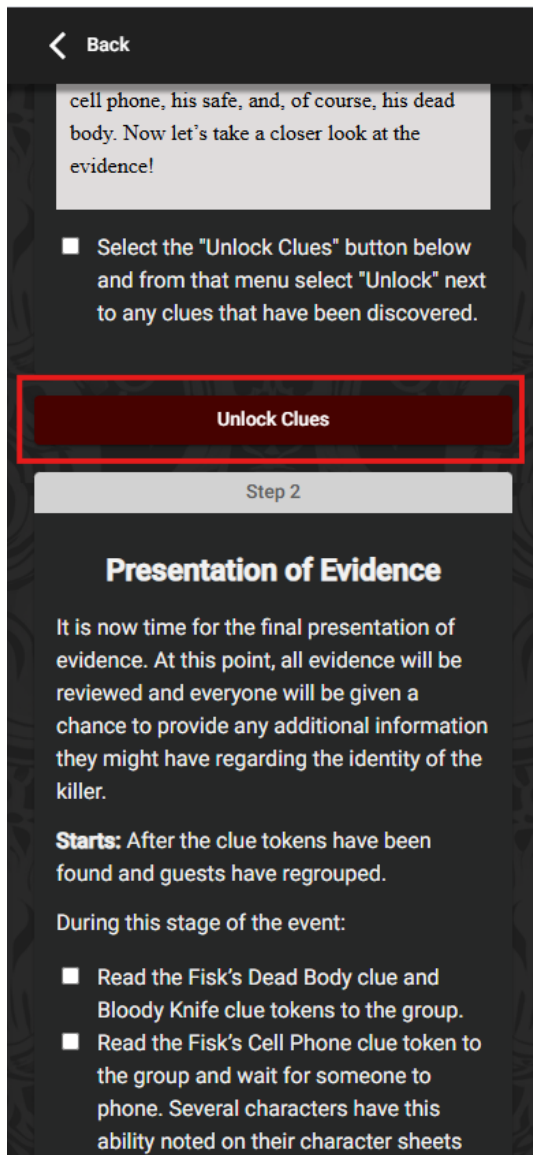

Ending the Game

The app will guide you through each act of the game, including the final voting period and the unmasking of the culprit. When you've finished the final act, you will be offered the option to "Conclude Game". Pushing that button will show a final concluding screen to all players on their apps, which summarizes and ends the game.

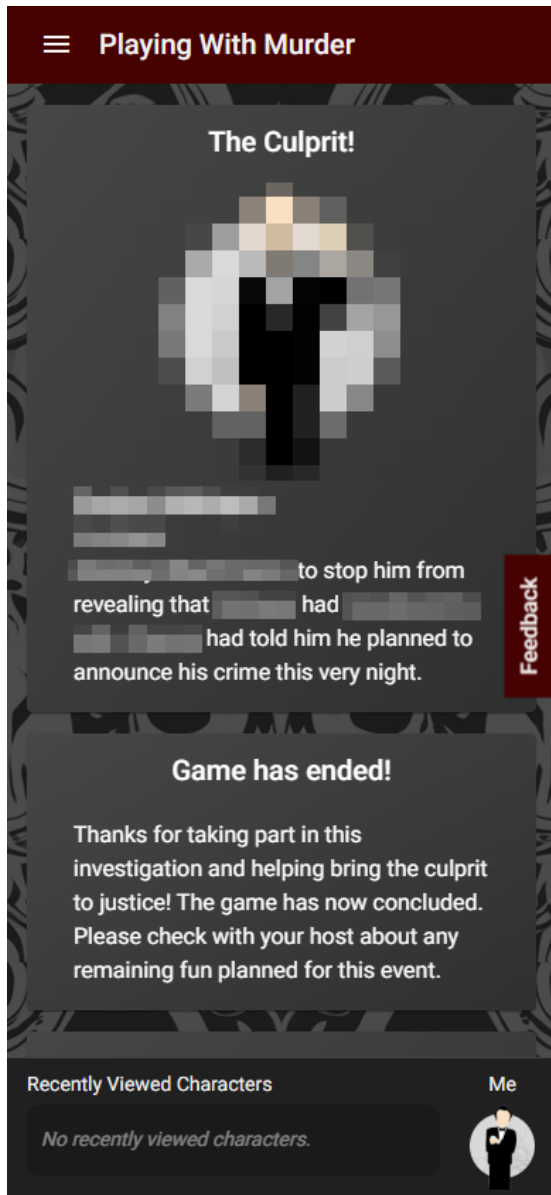

And that's it! The game is then concluded. You will be invited to share your thoughts about the app in a survey that will be shown in the app (see next page for details).

Sharing Feedback

We invite you and your guests to share your experience with the app by selecting the “Feedback” button and leaving comments about any changes you’d like to see in the app (see screenshots).

All feedback is reviewed by our team, and your comments are used to guide how we improve the game. Thanks in advance if you choose to leave feedback!

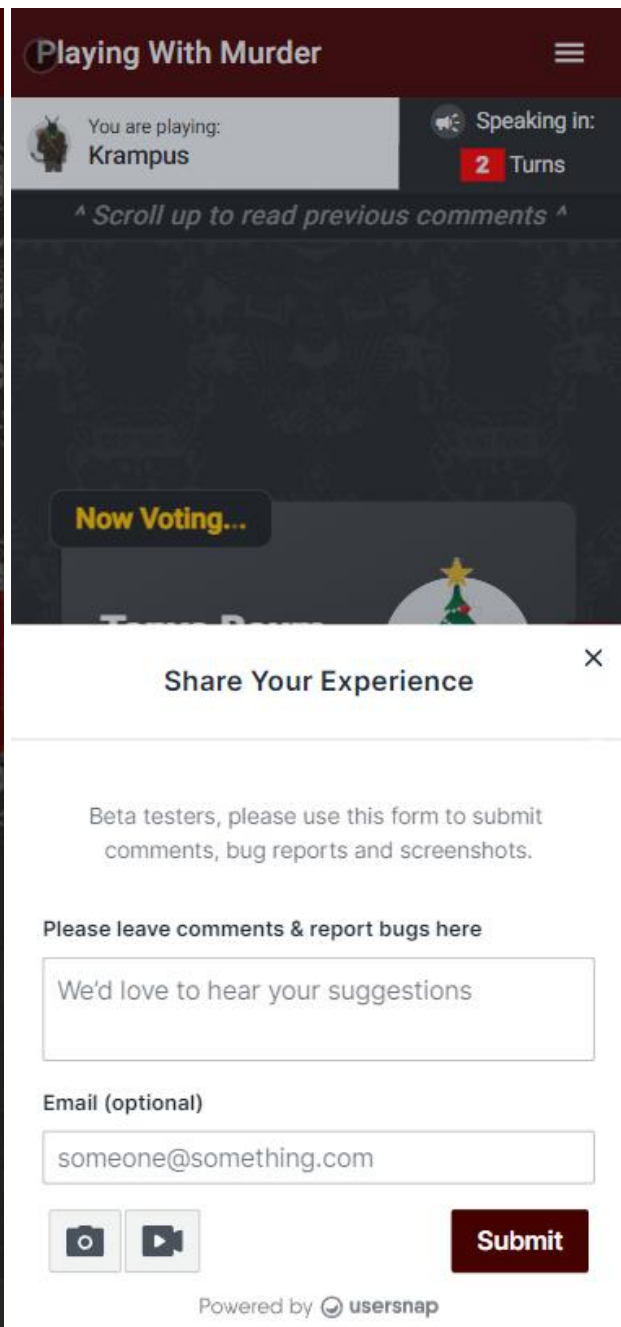

Troubleshooting

Occasionally, a player might have a technical issue with the app. Refreshing (also called reloading) the page in that player's browser fixes most of these issues. Please direct any guest experiencing issues to try refreshing/reloading the page.

If you encounter an issue that is not fixed by refreshing/reloading the page, please contact service@playingwithmurder.com.

Questions?

Please email service@playingwithmurder.com with any questions you have about the app. We will get back to you as soon as possible with answers during our normal business hours (9-5pm CT, M-F).